

JZG2系列小型功率继电器是在消化吸收国内外先进技术的基础上研制开发的一种新型通用继电器，具有结构设计合理、体积小、容量大、耐压性能好、工作可靠、寿命长、安装使用方便等特点，适用于交流50/60Hz，电压至220V或直流电压至110V，额定电流为5A或10A的电气回路，可广泛应用于各种工业自动化控制场合，作接通或分断电路之用。产品符合GB14048标准以及IEC60255、IEC60947和日本JIS标准。

JZG2 series miniature power relay is a new type general-purpose relay, which is designed on the basis of absorbing advanced technology at home and abroad. It has specialties of rational structure design, small size, large make and break capacity, high dielectric strength, good reliability, long life, easy to mounting and use, etc. It is suitable for electrical circuit with frequency 50Hz or 60Hz, voltage up to 220VAC or 110VDC, rated operation current up to 5A or 10A. It can be widely used for making and breaking circuits of industrial automatic control. The products are in compliance with the standard of GB14048 and IEC60255, IEC60947 and JIS.



型号含义 Type number nomenclature

JZG2-□□/□

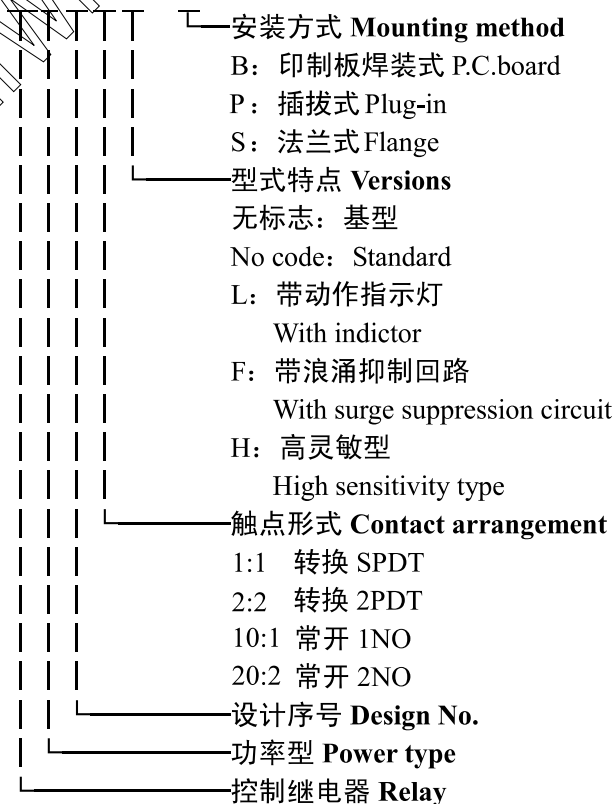

特点 Feature

- 体积小、省空间
- 开闭容量大，1极可达10A，2极为5A
- 线圈触点间耐压为2500V，耐浪涌电压达15000V
- 线圈触点间绝缘距离大于8mm
- 安装方式有插拔式、法兰式、印制板焊装式等多种
- Small size, light weight, beautiful figure
- Large capacity, SPDT 10A, 2PDT 5A
- Dielectric strength between coil and contact 2500V, dielectric strength of surge suppression voltage 15000V
- Insulation gap between coil and contact more the 8mm
- Variable mounting methods such as plug-in, flange, P.C.board.

JZG2

MINIATURE POWER RELAY小型功率继电器

规格品种 Specifications

型式 Versions		继电器型号 Relay type				额定电压 (Us) Rated voltage
		1 常开 1NO	1 转换 SPDT	2 常开 2NO	2 转换 2PDT	
印制板 焊装式 P.C. Board	基型 Standard	JZG2-10/B	JZG2-1/B	JZG2-20/B	JZG2-2/B	AC12, 24, 110, 220V DC5, 6, 12, 24, 48, 110V
	高灵敏度 High sensitivity	JZG2-10H/B	JZG2-1H/B	JZG2-20H/B	JZG2-2H/B	DC5, 6, 12, 24, 48V
插拔式 Plug-in	基型 Standard	—	JZG2-1/P	—	JZG2-2/P	AC12, 24, 110, 220V DC5, 6, 12, 24, 48, 110V
	带动作指示灯 With indicator	—	JZG2-1L/P	—	JZG2-2L/P	—
	带浪涌抑制回路 With surge suppression circuit	—	JZG2-1F/P	—	JZG2-2F/P	—
	带动作指示灯 及浪涌抑制回路 With indicator & surge suppression circuit	—	JZG2-1FL/P	—	JZG2-2FL/P	DC5, 6, 12, 24, 48V
法兰式 Flange	基型 Standard	JZG2-10/S	JZG2-1/S	—	—	AC12, 24, 110, 220V DC5, 6, 12, 24, 48, 110V

技术参数 Technical data

触点数量 Contact	1 常开, 1 转换 1NO, SPDT	2 常开, 2 转换 2NO, 2PDT
接触电阻 Contact resistance	30mΩ	50mΩ
动作电压 Pick-up voltage	AC: 80%Us DC: 70%Us	
释放电压 Drop-out voltage	AC: 30%Us DC: >10%Us	
最大通电电压 Max. supply voltage	110%Us	
动作时间 Operating time	15ms	
释放时间 Release time	AC: 15ms DC: 5ms (带浪涌抑制回路 With surge suppression circuit:20ms)	
额定功耗 Power consumption	AC: 0.9VA DC: 0.53W	
开闭频率 Operating cycle	≤ 30 cpm	
绝缘电阻 Insulation resistance	100MΩ	
工频耐压 Dielectric strength	线圈与触点间: AC2500V 1min 2500VACrms 1min between coil and contact	
	触点极间: AC2500V 1min 2500VAC rms 1min between contacts of different polarities	
	同组触点间: AC1000V 1min 1000VAC rms 1min between open contacts	

振动 Vibration	10~55Hz, 1.5mm 振动强度和振动稳定性 Malfunction durability and mechanical durability
冲击 Shock	200m/s ² (20G)励磁 Exciting 100m/s ² (10G)非励磁 No exciting 冲击稳定性 Mechanical durability
	1000m/s ² (100G) 冲击强度 Malfunction durability
环境温度 Temperature range	-40~+70℃
机械寿命 Mechanical life	1×10 ⁷
电寿命 lectrical life	1×10 ⁵
产品重量 Net weight	17g

触点容量 Contact ratings

型号 Type	JZG2-1, JZG2-10		JZG2-2, JZG2-20	
额定负载 Rated load	阻性负载 Res. load Cos φ =1	感性负载 Ind. load Cos φ =0.4L/R=7ms	阻性负载 Res. load Cos φ =1	感性负载 Ind. load Cos φ =0.4L/R=7ms
额定负载 Rated load	AC250V 10A DC30V 10A	AC250V 7.5A DC30V 5A	AC250V 5A DC30V 5A	AC250V 2A DC30V 3A
额定发热电流 Rated thermal current	10A		5A	
最大工作电压 Max. operational voltage	AC380V DC125V		AC380V DC125V	
最大工作电流 Max. operational current	10A		5A	
最大开闭容量 Max. making and breaking capacity	AC2500VA DC300W	AC1875VA DC150W	AC1250VA DC150W	AC500VA DC90W

外形尺寸及安装尺寸 Dimensions, mm

■ 印制板焊装式 P.C. board

- JZG2-1/B
- JZG2-1H/B
- JZG2-10/B
- JZG2-10H/B

■ 开孔尺寸 P.C. board drilling

- JZG2-1/B
- JZG2-1H/B
- JZG2-10/B
- JZG2-10H/B

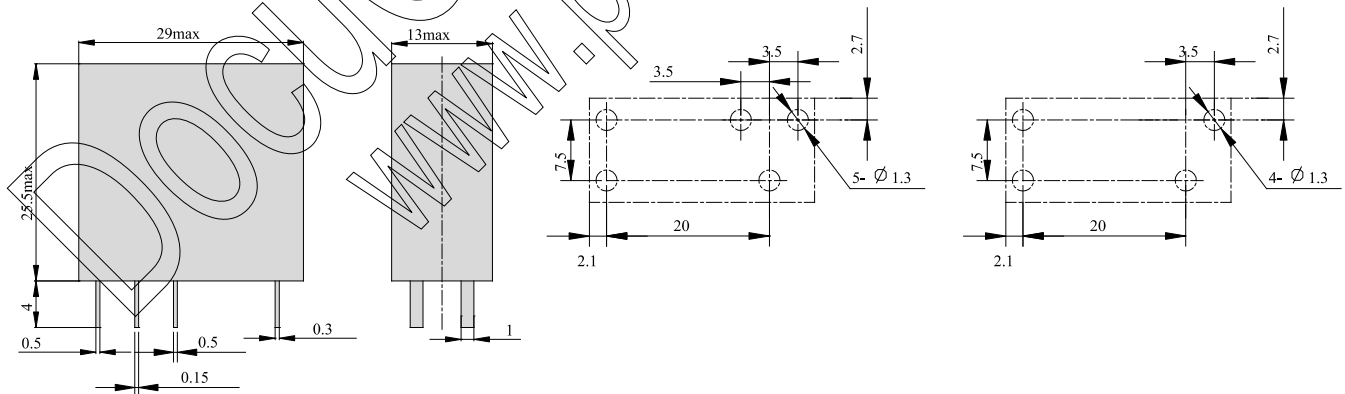

接线图 Wiring diagrams

- JZG2-1/B
- JZG2-1H/B
- JZG2-10/B
- JZG2-10H/B

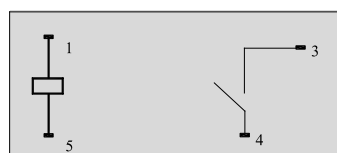
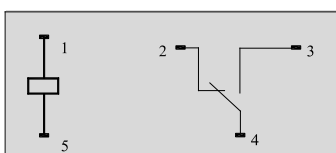

JZG2

MINIATURE POWER RELAY 小型功率继电器

规格品种 Specifications

■ 印制板焊装式 P.C. board

- JZG2-2/B
- JZG2-2H/B
- JZG2-20/B
- JZG2-20H/B

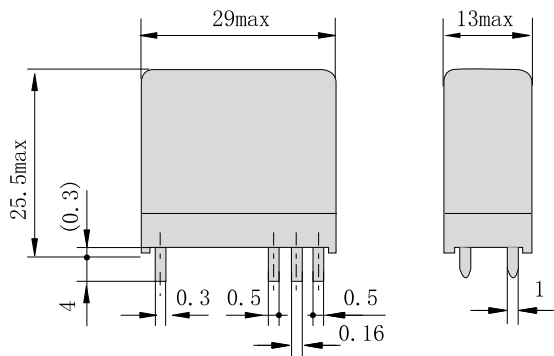

■ 开孔尺寸 P.C. board drilling

- JZG2-2/B
- JZG2-2H/B
- JZG2-20/B
- JZG2-20H/B

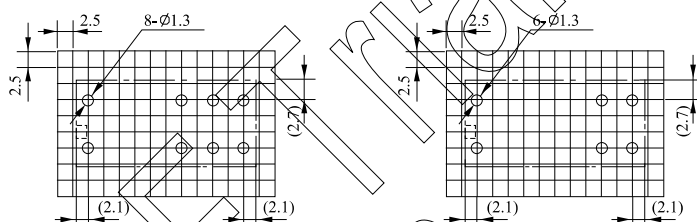

接线图 Wiring diagrams

- JZG2-2/B
- JZG2-2H/B
- JZG2-20/B
- JZG2-20H/B

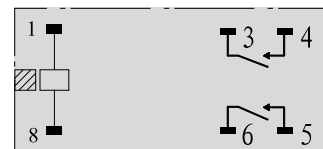
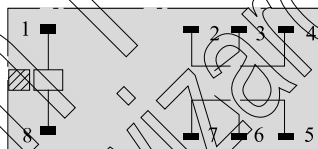

(端子方向观测 Bottom view)

■ 法兰式 Flange

- JZG2-1/S
- JZG2-10/S

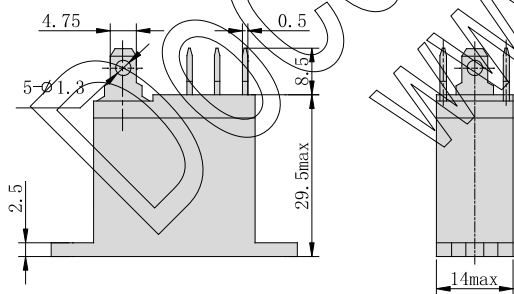

■ 开孔尺寸 Panel drilling

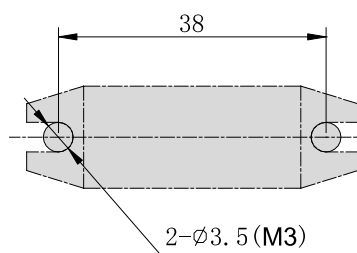

接线图 Wiring diagrams

- JZG2-1/S
- JZG2-10/S

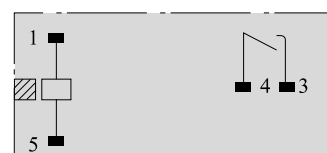
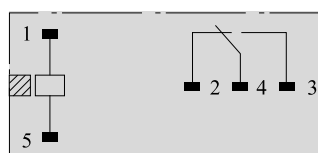

■ 插拔式 Plug-in

- JZG2-1/P
- JZG2-1L/P
- JZG2-1F/P
- JZG2-1FL/P

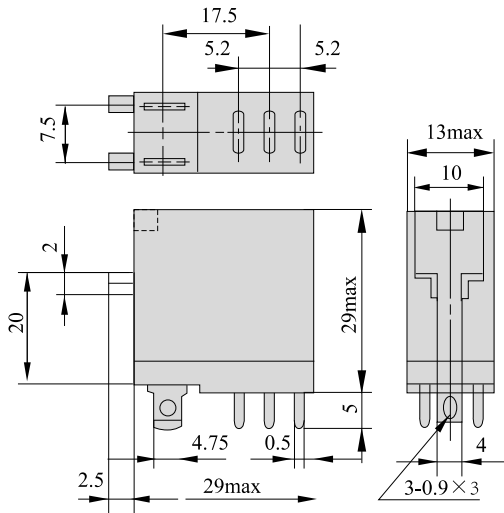

接线图 Wiring diagrams

● JZG2-1/P

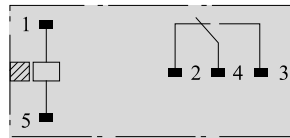

● JZG2-1L/P (AC)

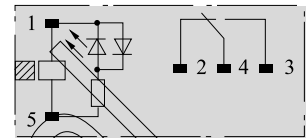

● JZG2-1L/P (DC)

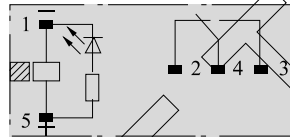

● JZG2-1F/P (DC)

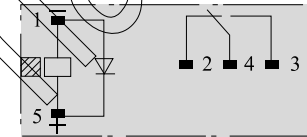

● JZG2-1FL/P (DC)

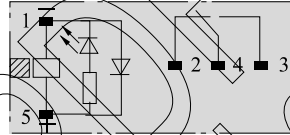

(端子方向观测 Bottom view)

■ 插拔式 Plug-in

- JZG2-2/P
- JZG2-2L/P
- JZG2-2F/P
- JZG2-2FL/P

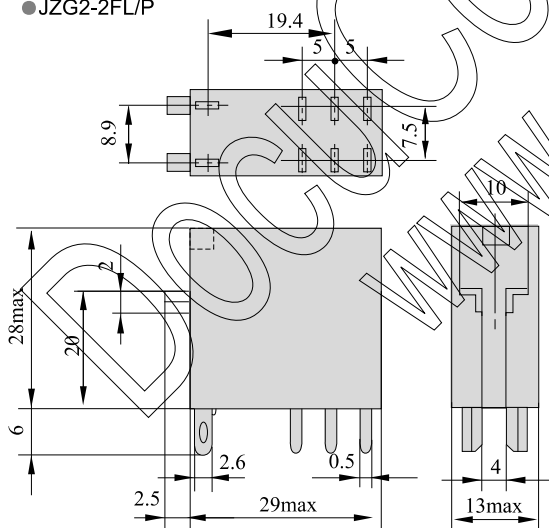

接线图 Wiring diagrams

● JZG2-2/P

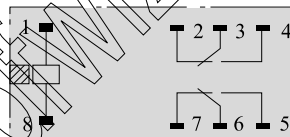

● JZG2-2L/P (AC)

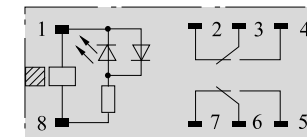

● JZG2-2L/P (DC)

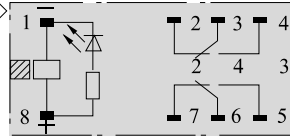

● JZG2-2F/P (DC)

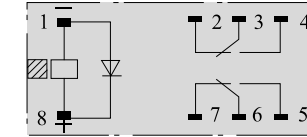

● JZG2-2FL/P (DC)

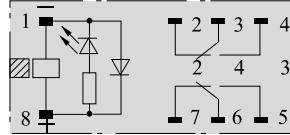

(端子方向观测 Bottom view)

安装插座 (适用于插拔式) Socket (for plug-in type)

适用继电器 Combined relay	插座型号 Socket type		
	导轨式 Track mounting	焊接式 Soldering	印制板焊装式 P.C.boa
JZG2-1□/P	TP35X	TP35	TP35B
JZG2-1□/P	TP38X	TP38	TP38B

插座外形尺寸及安装尺寸 Dimensions, mm/Socket

● TP35X, TP38X

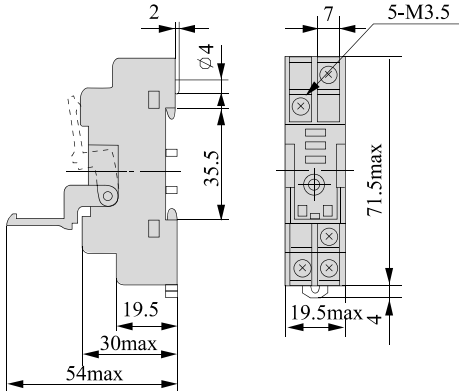

接线图Wiring diagrams

● TP35X

● TP38X

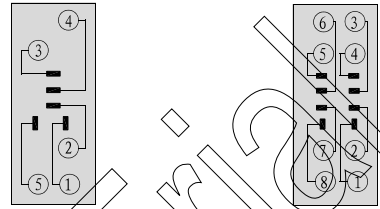

重量	TP35X	TP38X
NW	30g	35g

俯视方向观测Top view

● TP35, TP38

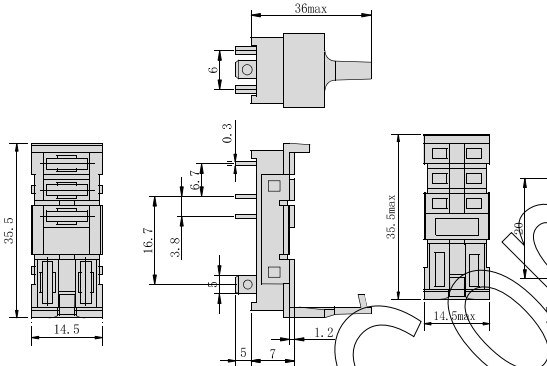

接线图Wiring diagrams

● TP35

● TP38

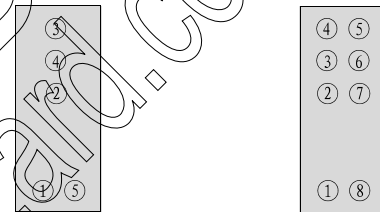

重量	TP35	TP38
NW	8g	10g

俯视方向观测Top view

● TP35B, TP38B

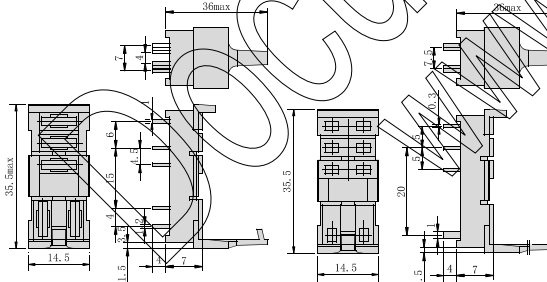

接线图Wiring diagrams

● TP35B

● TP38B



重量	TP35	TP38
NW	8g	10g

俯视方向观测Top view

开孔尺寸Panel drilling

● TP35X

● TP35

● TP35B

● TP38B

● TP38X

● TP38

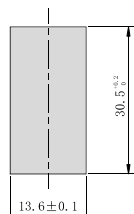
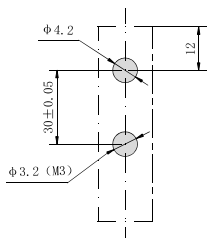

面板厚Panel: 1.6~2.0mm

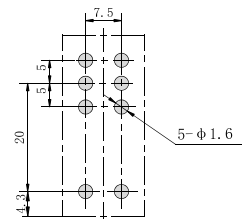
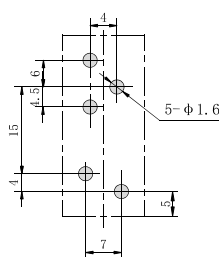

(铜箔方向观测Bottom view)